

Two Ways to Access the Bulk Location Mapping Screens

A. Edit Mode Access

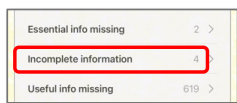

A1. Tap 'Closed Lock' to enter edit-mode.



A2. Tap 'Incomplete Information' to drop-down available categories

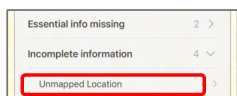

A3. Select 'Unmapped Locations'

B. Import Access

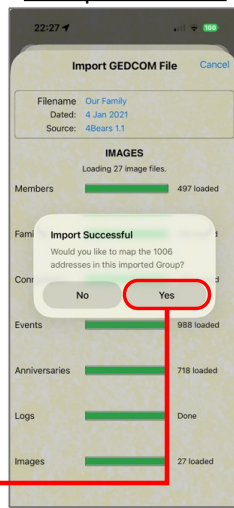

The 'Unmapped Locations' screen lets you quickly map addresses that have been imported into Forebears as text.

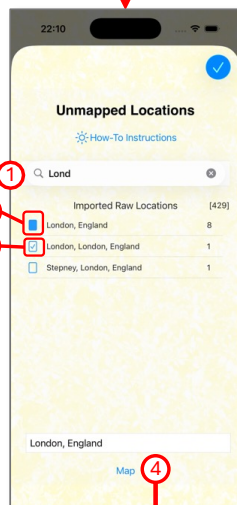

Step 1: It is often best to enter a rough location (e.g. London or Ohio) into the search-bar to filter on addresses that may be the same.

Step 2: Then tap an address row that most closely matches the location. The first address you select from the table is highlighted with solid blue box and will be used to drive the mapping process. Tapping the row again clears all selections.

Step 3: After tapping the prime address, you can select further addresses that you'd like to share this mapped location because they are the same place but described differently. Tapping the row again cancels the row.

Step 4: Tap the 'Map' button to open the Address Mapping Screen.

Step 5: Tap the 'Lookup' button to instruct Forebears to search for the grid reference and locate the address on a map. *(Note: If the address cannot be found, check the spelling of the raw address and make changes before trying again. Remember that not all historic locations have an exact match on today's maps so you may need to be flexible!)*

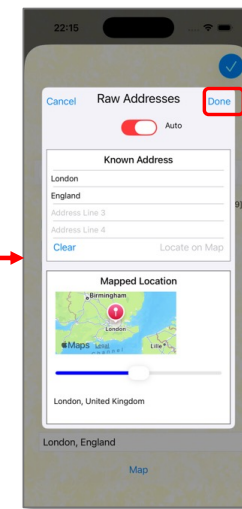
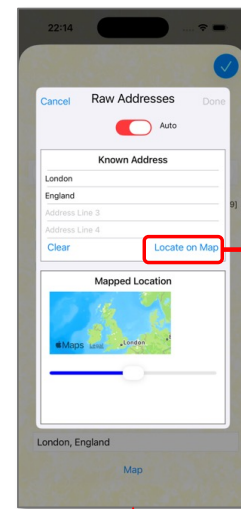

Step 6: Tapping 'Done' captures the grid reference.

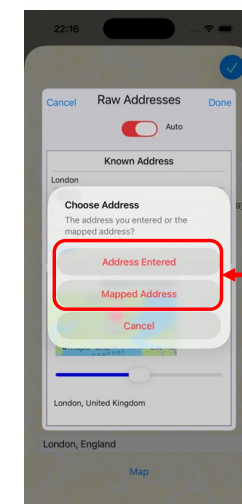

Step 7: The street address is your choice. Whether to use the Address Entered (which may be historically correct) or the Mapped Address (the location on today's maps)